



ICENOGLE SEAVER POGUE

December 3, 2015

Weld County Assessor
Weld County Colorado
915 10th Street
Greeley, Colorado 80632

**Re: Hidden Creek Metropolitan District
Boundary Map**

To Whom It May Concern:

Pursuant to Section 32-1-306, C.R.S., enclosed for your files is a copy of the boundary map for Hidden Creek Metropolitan District.

To confirm for our records that you have received the Boundary Map, please sign the enclosed Acknowledgement and return it to our office in the enclosed, self-addressed, stamped envelope.

Sincerely,

ICENOGLE SEAVER POGUE
A Professional Corporation

Donette B. Hunter
Paralegal

/DBH

Enclosure

cc: Tamara K. Seaver (w/o enclosures)
Jennifer L. Ivey (w/o enclosures)

Donette B. Hunter | *DHunter@isp-law.com* | *Direct 303.867.3001*

4725 S. Monaco St., Suite 225 | Denver, CO 80237 | 303.292.9100 | fax 303.292.9101 | www.isp-law.com

ACKNOWLEDGEMENT

Received this ____ day of _____, 2015, from Icenogle Seaver Pogue, P.C., the boundary map for **Hidden Creek Metropolitan District**.

WELD COUNTY ASSESSOR

By: _____
Printed Name: _____
Title: _____

HIDDEN CREEK DISTRICT SERVICE PLAN EXHIBIT C - DISTRICT BOUNDARY MAP

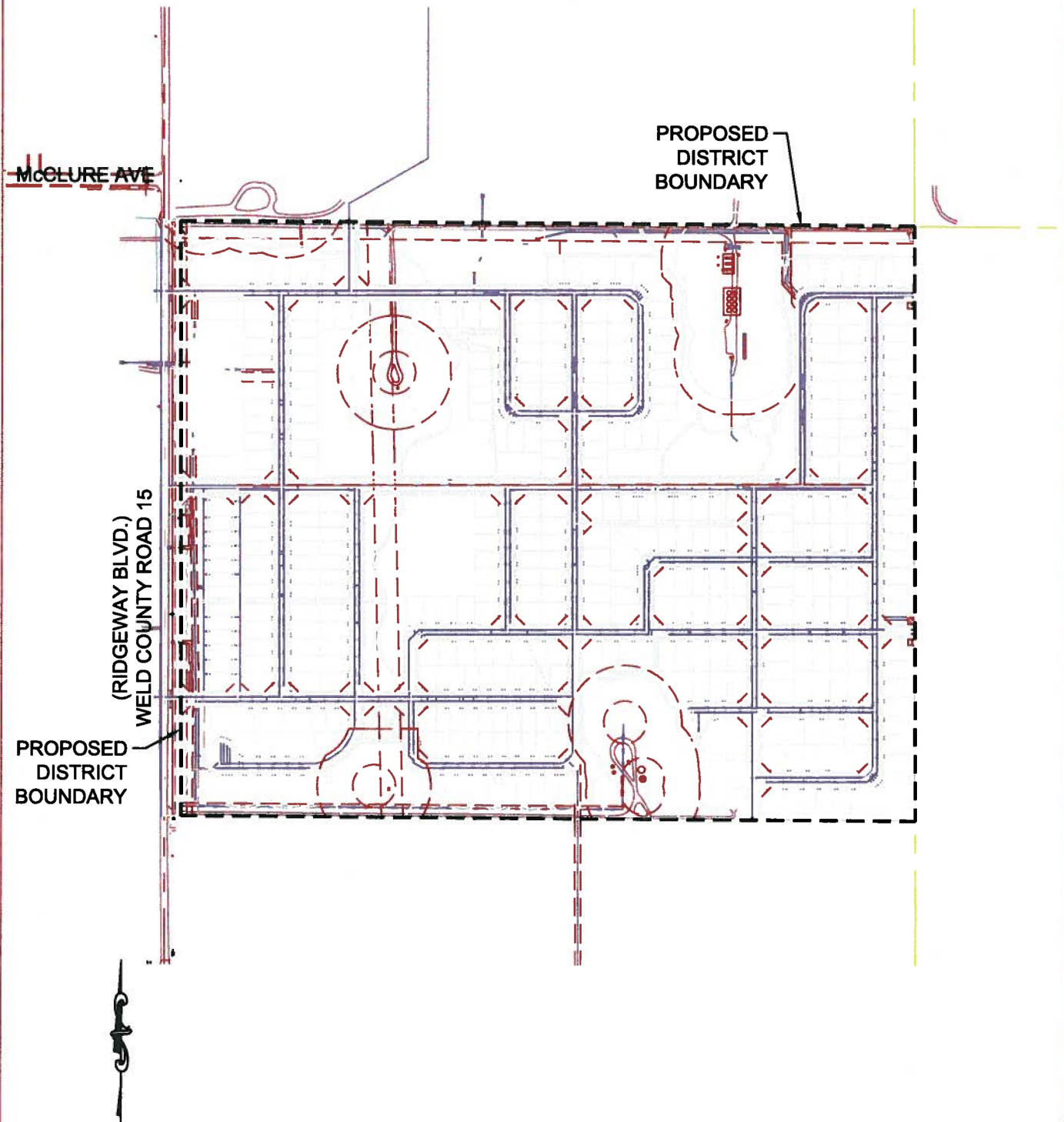

NOT TO SCALE

LEGAL DESCRIPTION – HIDDEN CREEK SUBDIVISION

A PARCEL OF LAND BEING THE SOUTHWEST QUARTER OF SECTION 29, TOWNSHIP 2 NORTH, RANGE 67 WEST OF THE SIXTH PRINCIPAL MERIDIAN, COUNTY OF WELD, STATE OF COLORADO, EXCEPT THE SOUTH 557.0 FEET AS CONVEYED AND DESCRIBED IN DEED RECORDED DECEMBER 31, 1969 AT RECEPTION NO. 1540912 IN BOOK 619, BEING MORE PARTICULARLY DESCRIBED AS FOLLOWS:

BEGINNING AT THE WEST QUARTER CORNER OF SAID SECTION 29;

THENCE SOUTH 89°40'46" EAST ALONG THE NORTHERLY LINE OF THE SOUTHWEST QUARTER OF SAID SECTION 29 A DISTANCE OF 2638.10 FEET TO THE CENTER QUARTER OF SAID SECTION 29;

THENCE SOUTH 00°11'58" EAST ALONG THE EASTERLY LINE OF SAID SOUTHWEST QUARTER A DISTANCE OF 2088.57 FEET TO A POINT;

THENCE NORTH 89°41'28" WEST PARALLEL WITH AND 557.00 FEET NORTHERLY OF THE SOUTHERLY LINE OF SAID SOUTHWEST QUARTER A DISTANCE OF 2638.91 FEET TO A POINT ON THE WESTERLY LINE OF SAID SOUTHWEST QUARTER;

THENCE NORTH 00°10'38" WEST ALONG SAID WESTERLY LINE A DISTANCE OF 2089.10 FEET TO THE POINT OF BEGINNING.

CONTAINING 126.519 ACRES, MORE OR LESS